

Measurement Report

PROPERTY
 9 Bethune Way

CLIENT
 Tara Molina

MEASUREMENT DATE
 May 22, 2026

JOB #
 073874

Area	Methodology	Value
Total Floor Area Above Grade (RMS Value)	RMS	1,475.4 ft²
Floor Area Main Level	RMS	728.1 ft ²
Floor Area Below Grade (Including Basement)	Finished Area	N/A or Not Measured
Other Non-RMS Areas (e.g. Separate Structures)	Finished Area	N/A or Not Measured
Finished Area Measured	RMS + Finished Area	1,475.4 ft ²

Room Dimensions

Room	Dimensions	Level	Room	Dimensions	Level
Entrance	8'6" x 8'10"	Main	Laundry	7'0" x 5'1"	Upper 1
Living	13'5" x 16'11"	Main	Primary Bedroom	13'1" x 12'6"	Upper 1
Dining	8'9" x 14'5"	Main	Walk-in Closet	7'3" x 8'0"	Upper 1
Kitchen With Eating Area	12'10" x 13'11"	Main	Ensuite 3P	4'11" x 8'1"	Upper 1
Mud Room	5'9" x 4'6"	Main	Flex Room - Unfinished	30'5" x 19'5"	Basement
Bathroom 2P	2'11" x 6'8"	Main	Furnace/Utility Room - Unfinished	11'10" x 6'10"	Basement
Bedroom	11'6" x 9'4"	Upper 1			
Bedroom	11'5" x 9'1"	Upper 1			
Bathroom 4P	8'7" x 5'4"	Upper 1	Attached Garage	34'11" x 23'5"	

Bathrooms

1-Pc Bath	2-Pc Bath	3-Pc Bath	4-Pc Bath	5-Pc Bath	6-Pc Bath
	1		1		
1-Pc Ensuite	2-Pc Ensuite	3-Pc Ensuite	4-Pc Ensuite	5-Pc Ensuite	6-Pc Ensuite
		1			

Disclaimer: For use by real estate professionals only to assist with the sale of the property noted herein. Report provides measurements only and no evaluations of the property have been performed. Report values are based on RECA's requirements for RMS measurements and are in compliance with same (see [RECA's Guide to the RMS](#)). Said area values are derived from perimeter measurements (not individual room dimensions). Areas not allowed under RMS are excluded from the area total. Non-RMS area measurements are included only upon request and when ordered are measured with finished and unfinished space identified according to the ANSI Z765 standard. As part of your duty of care to your client and knowing this property best, please review the contents of this report carefully to confirm all areas of the property have been accounted for. REALTORS® working with buyers should verify the measurements herein before relying on them as part of an offer. Please notify us immediately of any identified discrepancies so that we may address any issues. ListSimple accepts no responsibility for any discrepancies identified more than 14 days past the report date. For full terms visit listsimple.com/terms

MEASUREMENT DETAILS

Exterior Wall Approach	Exterior Wall Thickness
Detached / Semi-Detached / Townhouse	6.5 "

RMS Areas

Level	Total Area	Exclusions	Total Exclusions	RMS Area
Main	728.1 ft ²			728.1 ft ²
Upper 1	747.3 ft ²			747.3 ft ²
TOTAL				1,475.4 ft²

Non-RMS Areas

Level/Space	Total Area	Unfinished Areas	Total Unfinished	Finished Area
Basement	647.1 ft ²	Basement - 647.1 ft ²	647.1 ft ²	0.0 ft ²
TOTAL			647.1 ft²	0.0 ft²

Disclaimer: For use by real estate professionals only to assist with the sale of the property noted herein. Report provides measurements only and no evaluations of the property have been performed. Report values are based on RECA's requirements for RMS measurements and are in compliance with same (see [RECA's Guide to the RMS](#)). Said area values are derived from perimeter measurements (not individual room dimensions). Areas not allowed under RMS are excluded from the area total. Non-RMS area measurements are included only upon request and when ordered are measured with finished and unfinished space identified according to the ANSI Z765 standard. As part of your duty of care to your client and knowing this property best, please review the contents of this report carefully to confirm all areas of the property have been accounted for. REALTORS® working with buyers should verify the measurements herein before relying on them as part of an offer. Please notify us immediately of any identified discrepancies so that we may address any issues. ListSimple accepts no responsibility for any discrepancies identified more than 14 days past the report date. For full terms visit [listsimple.com/terms](https://www.listsimple.com/terms)

SUPPORTING PLANS

Main

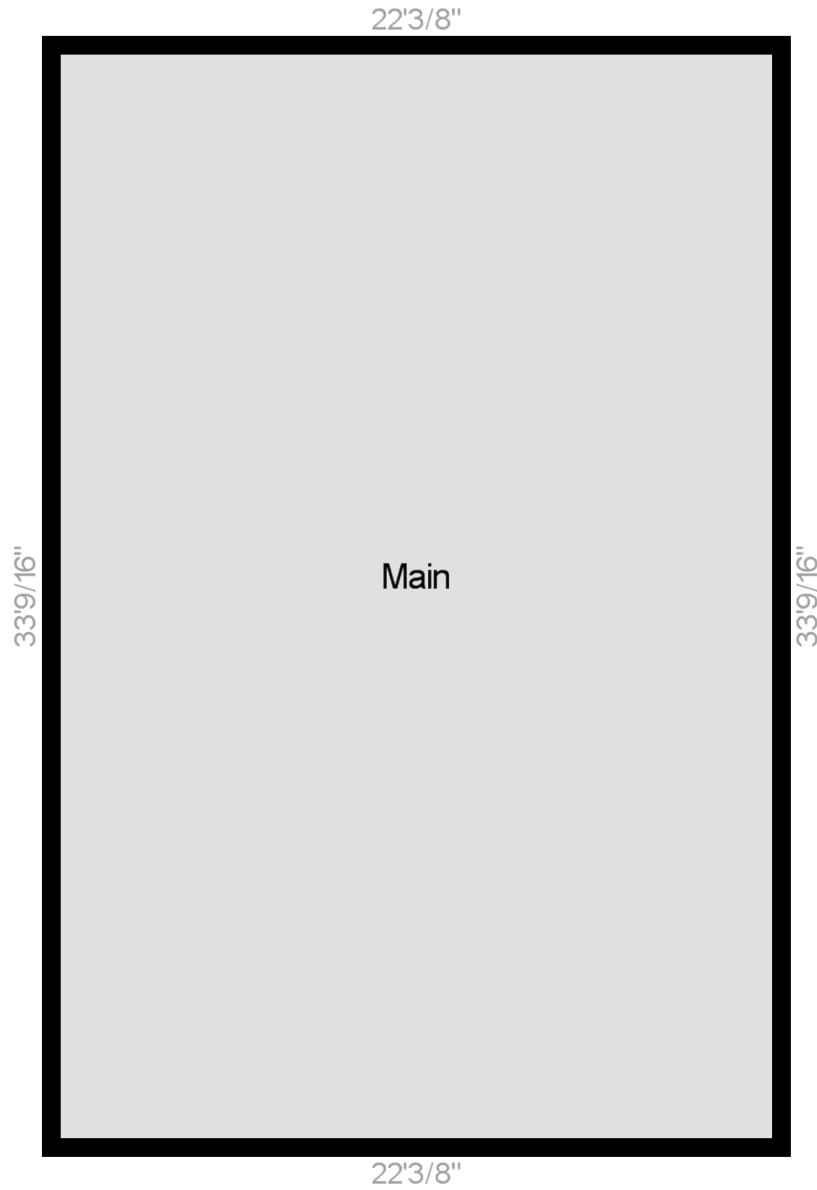

SUPPORTING PLANS

Upper 1

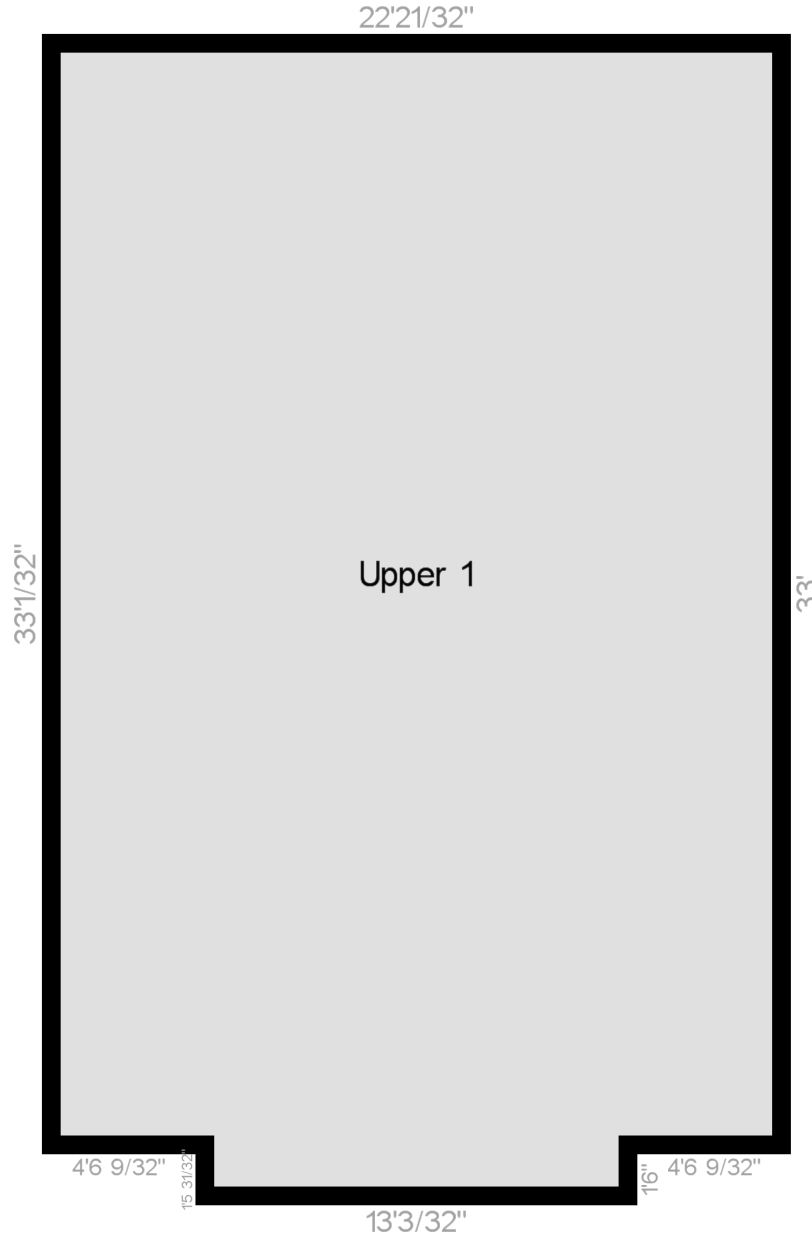

SUPPORTING PLANS

Basement

20'6 1/32"

20'6 1/32"

31'6 23/32"

Basement

31'6 23/32"
31'6 23/32"

Basement -
Unfinished

31'6 23/32"

20'6 1/32"

20'6 1/32"